

**TTK 30 E**

**EN**

**OPERATING MANUAL**  
DEHUMIDIFIER



**TROTEC**

**Table of contents**

Notes regarding the operating manual..... 1

Safety ..... 2

Information about the device..... 3

Transport and storage..... 4

Assembly and installation..... 5

Operation ..... 6

Errors and faults ..... 10

Maintenance ..... 11

Technical annex..... 14

Disposal ..... 16

**Notes regarding the operating manual**

**Symbols**



**Warning of electrical voltage**

This symbol indicates dangers to the life and health of persons due to electrical voltage.



**Warning!**

This signal word indicates a hazard with an average risk level which, if not avoided, can result in serious injury or death.



**Caution!**

This signal word indicates a hazard with a low risk level which, if not avoided, can result in minor or moderate injury.

**Note**

This signal word indicates important information (e.g. material damage), but does not indicate hazards.



**Info**

Information marked with this symbol helps you to carry out your tasks quickly and safely.



**Follow the manual**

Information marked with this symbol indicates that the operating manual must be observed.

The current version of the operating manual can be found at:



TTK 30 E



<http://download.trotec.com/?sku=1120000034&id=1>

**Legal notice**

This release replaces all previous versions. No part of this publication may be reproduced without written permission from Trotec GmbH & Co. KG. The same applies for electronically processing, duplicating or spreading the publication. Subject to technical changes. All rights reserved. Trademarks are used without guarantee that they may be used freely and primarily following the spelling of the manufacturer. Product names are registered.

Changes to construction in the interests of constant improvements to the product, as well as changes to the shape and colour are reserved.

The scope of delivery may vary from product images. This document was created with all due care. Trotec GmbH & Co. KG accepts no liability whatsoever for possible mistakes or omissions.

© Trotec GmbH & Co. KG

## Warranty and liability

The device complies with the fundamental health and safety requirements of the applicable EU regulations and was tested at the factory for perfect functionality multiple times.

However, if faults in the functionality occur and cannot be remedied with the measures in the chapter Errors and faults, please get in touch with your dealer or distributor.

When making a warranty claim, supply the device number (see the rear of the device).

When manufacturer's instructions or legal regulations have not been followed, or after unauthorised changes to the device are made, the manufacturer is not responsible for the resulting damages. Changes to the device or unauthorised replacement of individual parts can drastically impact the electrical safety of this product and will result in the loss of the warranty. Liability does not extend to damages to people or property caused by the device being used other than as described in the instructions in this operating manual. Subject to changes to technical design and model changes as part of constant development and product improvement without prior notice.

No liability is accepted for damages resulting from improper use. In such a case, any warranty claims will be voided also.

## Safety

**Read this manual carefully before starting or using the device. Always store the manual in the immediate vicinity of the device or its site of use!**

- Do not use the device in potentially explosive rooms.
- Do not use the device in aggressive atmosphere.
- Set the device up in an upright and stable position.
- Let the device dry out after a wet clean. Do not operate it when wet.
- Do not use the device with wet or damp hands.
- Do not expose the device to directly squirting water.
- Never insert any objects or limbs into the device.
- Do not cover or transport the device during operation.
- Do not sit on the device.
- This appliance is not a toy! Keep away from children and animals. Do not leave the device unattended during operation.
- Check accessories and connection parts for possible damage prior to every use of the device. Do not use any defective devices or device parts.
- Ensure that all electric cables outside of the device are protected from damage (e.g. caused by animals). Never use the device if electric cables or the power connection are damaged!
- The electrical connection must correspond to the specifications in chapter Technical data.

- Insert the mains plug into a properly secured mains socket.
- Observe the device's power input, cable length and intended use when selecting extensions to the power cable. Completely unroll extension cables. Avoid electrical overload.
- Before carrying out maintenance, care or repair work on the device, remove the mains plug from the mains socket. Hold onto the mains plug while doing so.
- Switch the device off and disconnect the power cable from the mains socket when the device is not in use.
- Do not under any circumstances use the device if you detect damages on the mains plug or power cable. Defective power cables pose a serious health risk.
- Observe the storage and operating conditions (see chapter Technical data).
- Ensure that the air inlet and outlet are not obstructed.
- Ensure that the side of the device where the air inlet is found is kept free of dirt and loose objects.
- Only transport the device in an upright position with an emptied condensation tank or drain hose.
- Discharge the collected condensate before transport and storage. Do not drink it. Health hazard!

## Intended use

Only use the device for drying and dehumidifying room air, while adhering to and following the technical data.

In addition, the device may also be used as a kind of clothes dryer to dry wet laundry.

Intended use comprises:

- dehumidifying and drying:
  - living rooms, bedrooms, bathrooms and basements
  - laundries, holiday homes, camper vans, boats
- maintaining the dryness of:
  - storage spaces, archives, laboratories, garages
  - bathrooms, wash rooms, changing rooms etc.

## Improper use

- Do not place the device on wet or flooded ground.
- Do not place any objects, e.g. clothing, on the device.
- Do not use the device outdoors.
- Any unauthorised modifications, alterations or structural changes to the device are forbidden.
- Any operation other than as described in this manual is prohibited. Non-observance renders all claims for liability and guarantee null and void.

## Personnel qualifications

People who use this device must:

- be aware of the dangers that occur when working with electric devices in damp areas.
- have read and understood the operating manual, especially the Safety chapter.

Maintenance tasks which require the housing to be opened must only be carried out by specialist companies for cooling and air-conditioning or by Trotec.

## Residual risks



### Warning of electrical voltage

Work on the electrical components must only be carried out by an authorised specialist company!



### Warning of electrical voltage

Before any work on the device, remove the mains plug from the mains socket!  
Hold onto the mains plug while pulling the power cable out of the mains socket.



### Warning!

Dangers can occur at the device when it is used by untrained people in an unprofessional or improper way!  
Observe the personnel qualifications!



### Warning!

The device is not a toy and does not belong in the hands of children.



### Warning!

Do not leave the packaging lying around. Children may use it as a dangerous toy.

### Note

Do not operate the device without an inserted air filter!  
Without the air filter, the inside of the device will be heavily contaminated. This could reduce the performance and result in damage to the device.

## Behaviour in the event of an emergency

1. In an emergency, disconnect the device from the mains feed-in: Switch the device off and disconnect the power cable from the mains socket. Hold onto the mains plug while doing so.
2. Do not reconnect a defective device to the mains.

## Information about the device

### Description of the device

The device uses the principle of condensation to automatically dehumidify rooms.

The fan sucks damp room air through the air inlet, the air filter, the evaporator and to the condenser located behind it. The air is cooled at the cold evaporator until it is below the dew point. Water vapour contained in the room air precipitates on the evaporator fins as condensation or rime. The dehumidified, cooled air is slightly warmed at the condenser and blown out again. The drier air thus conditioned mixes with the air in the room. The humidity in the room where the device is positioned is reduced as air constantly circulates through the device.

Depending on the air temperature and the relative humidity, the condensed water either drops continuously or only during the defrost phase through the integrated drain nozzle into the condensation tank below. It is fitted with a float to measure the filling level.

The device has a control panel for operating and controlling the functions.

Once the maximum filling level of the condensation tank is reached or in case the condensation tank is not installed correctly, the condensation tank indicator light (see chapter Operating elements) on the control panel is illuminated. The device switches off. The condensation tank indicator light only goes out again once the emptied condensation tank is reinserted.

Optionally, the condensed water can be drained by attaching a hose at the condensation connection.

The device can reduce the relative humidity of a room to approx. 30 %.

The device provides additional assistance for drying wet laundry or clothing in living or working spaces.

Because of the heat radiation generated during operation, the room temperature may rise slightly.

## Device depiction

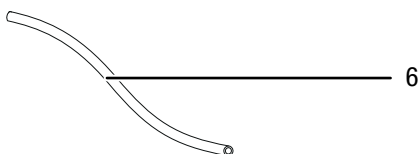
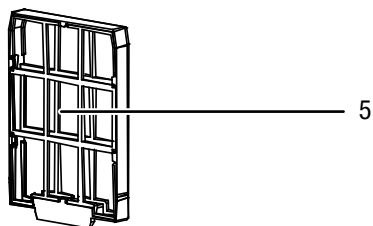
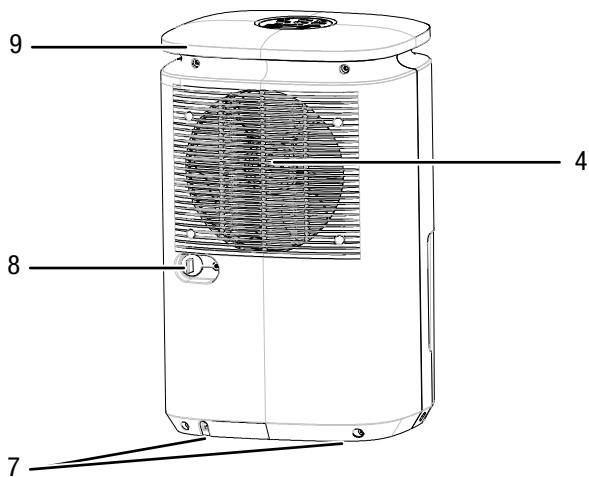
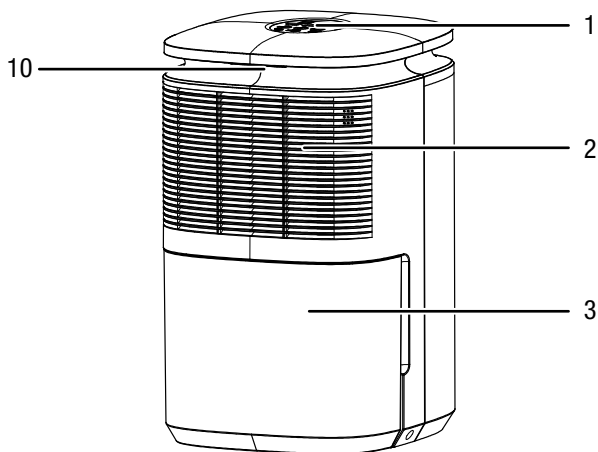

No.	Designation
1	Control panel
2	Air inlet with air filter
3	Condensation tank
4	Air outlet
5	Air filter
6	Condensation drain hose
7	Feet
8	Condensation drain hose connection
9	Transport handle / Power cable winder
10	Colour LED for current room humidity

## Transport and storage

### Transport

**Before** transporting the device, proceed as follows:

- Switch off the device.
- Hold onto the mains plug while pulling the power cable out of the mains socket.
- Drain the remaining condensate from the device and the condensation drain hose (see chapter Maintenance).
- Do not use the power cable to drag the device.

**After** transporting the device, observe the following:

- Set up the device in an upright position after transport.
- Leave the device to rest for 12 - 24 hours, so the refrigerant can accumulate within the compressor. Wait 12 - 24 hours before switching the device back on! Acting contrary might lead to compressor damage and a malfunctioning device. If so, any warranty claims will be voided.

### Storage

**Before** storing the device, proceed as follows:

- Drain the remaining condensate from the device and the condensation drain hose (see chapter Maintenance).
- Empty and clean the condensation tank prior to storage.

When the device is not being used, observe the following storage conditions:

- dry and protected from frost and heat
- in an upright position where it is protected from dust and direct sunlight
- with a cover to protect it from invasive dust if necessary
- Place no further devices or objects on top of the device to prevent it from being damaged.

## Assembly and installation

### Scope of delivery

- Device
- Condensation drain hose, length: 0.3 m, diameter: 17 mm
- Air filter
- Manual

### Unpacking the device

1. Open the cardboard box and take the device out.
2. Completely remove the packaging.
3. Fully unwind the power cable. Make sure that the power cable is not damaged and that you do not damage it during unwinding.

### Start-up

When positioning the device, observe the minimum distance from walls or other objects as described in chapter Technical Data.

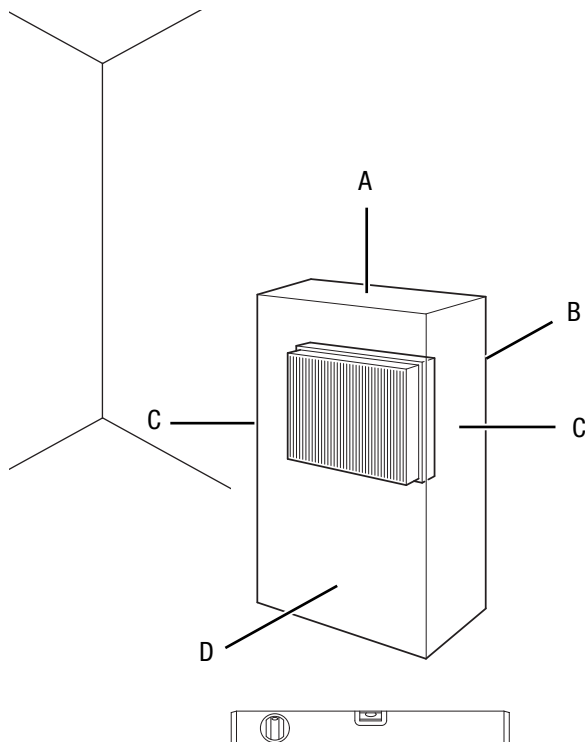

- Make sure that extension cables are completely unrolled.
- When positioning the device, keep a sufficient distance to heat sources.
- Make sure that no curtains or other objects interfere with the air flow.
- When positioning the device, particularly in wet areas, secure it locally with an RCD (residual current device) which complies with the respective regulations.

### Inserting the air filter

#### Note

Do not operate the device without an inserted air filter! Without the air filter, the inside of the device will be heavily contaminated. This could reduce the performance and result in damage to the device.

- Make sure that the air filter is installed before switching the device on.

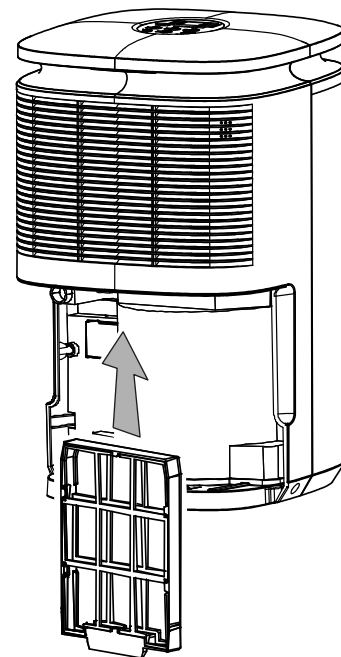

### Inserting the condensation tank

- Ensure that the float inside the condensation tank is inserted correctly.
- Ensure that the condensation tank is empty and inserted correctly.

### Connecting the power cable

- Insert the mains plug into a properly secured mains socket.

- Before restarting the device, check the condition of the power cable. If there are doubts as to the sound condition, contact the customer service.
- Set the device up in an upright and stable position.
- Do not create tripping hazards when laying the power cable or other electric cables, especially when positioning the device in the middle of the room. Use cable bridges.

## Operation

### Notes:

- Avoid open doors and windows.
- After being switched on, the device operates fully automatically.
- The fan permanently runs in dehumidification mode even after the set nominal value has been reached until the device is switched off.

### Operating elements

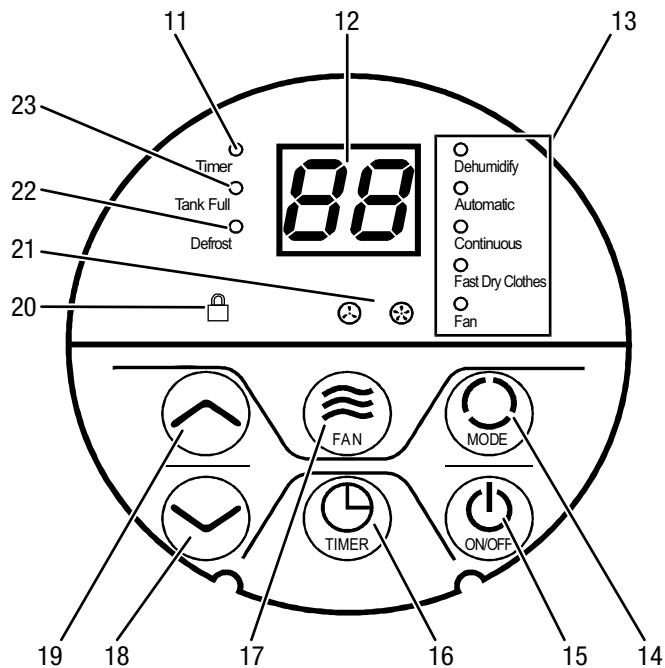

No.	Designation	Meaning
11	<i>Timer</i> indication	Illuminated when the timer is programmed
12	Segment display	Indicates the relative room humidity level Indicates the desired relative room humidity during setting Indicates continuous operation <i>CO</i> in <i>dehumidification</i> mode Indicates the number of hours during timer programming
13	<i>Operating modes</i> indication	Indication of active operating mode: Dehumidify = <i>Dehumidification</i> Automatic = <i>Automatic mode</i> Continuous = <i>Continuous operation</i> Fast Dry Clothes = <i>Laundry drying function</i> Fan = <i>Ventilation</i>
14	<i>MODE</i> button	Selection button for operating modes: <i>Dehumidification</i> <i>Automatic mode</i> <i>Continuous operation</i> <i>Laundry drying function</i> <i>Ventilation</i>
15	<i>ON/OFF</i> button	On/Off button: Switches the device on or off
16	<i>TIMER</i> button	Starts programming for the timer function
17	<i>FAN</i> button	Setting the fan speed in <i>dehumidification</i> and <i>ventilation</i> mode: ☹ = low ☹☹ = high
18	Arrow buttons	Setting the operating mode Setting the relative room humidity Setting the number of hours for the timer function
19		
20	<i>Child lock</i> indication	Illuminated when the child lock is active
21	<i>Fan speed</i> indication	Indication of the fan speed: ☹ = low ☹☹ = high
22	<i>Defrost</i> indication	Illuminated when automatic defrosting is in progress
23	<i>Tank Full</i> indication	Illuminated when the condensation tank is full

### Switching the device on

Once you have completely installed the device as described in the Start-up chapter, you can switch it on.

1. Press the *ON/OFF* button (15).  
⇒ The device starts in *automatic* mode.

### Setting the operating mode

#### Setting the relative room humidity

You can only change the relative room humidity in *dehumidification* mode.

1. Press the arrow buttons (18, 19) to adjust the relative room humidity. Setting is possible in the range between 30 % and 80 % in steps of 5 %.  
⇒ The desired relative room humidity is indicated in the segment display (12) for approx. 5 seconds. Then the current relative room humidity is displayed again.

### Dehumidification

The device keeps running until reaching the preselected relative room humidity. Then the compressor switches off and the fan keeps running. Once the preselected relative room humidity is exceeded, the compressor switches back on.

The relative room humidity can be set within a setting range from 30 % to 80 % in steps of 5 %. Additionally, the *CO* setting for permanent dehumidification (continuous operation) can be selected.

You can choose between low and high fan speed.

1. Press the *MODE* button (14).  
⇒ The indication of the currently selected operating mode flashes.
2. Press the arrow buttons (18, 19) until the LED for *dehumidification* mode (13) starts flashing.
3. Then press the *MODE* button (14) again.  
⇒ *Dehumidification* mode is selected.
4. Press the arrow buttons (18, 19) to adjust the relative room humidity or to select continuous operation (*CO*).
5. Press the *FAN* button (17) to select either low or high fan speed.  
⇒ The selected fan speed is indicated on the *fan speed* indication (21).

### Automatic operation

The relative room humidity is preset to 55 % and cannot be changed.

If the relative room humidity lies between 55 % and 70 %, the fan automatically switches over to low speed.

Below a relative room humidity of 55 %, the compressor switches off.

Above a relative room humidity of 70 %, the fan runs at the highest level.



#### Info

In automatic mode, the fan speed indication (21) does not change automatically.

1. Press the *MODE* button (14).  
⇒ The indication of the currently selected operating mode flashes.
2. Press the arrow buttons (18, 19) until the LED for *automatic* mode (13) starts flashing.
3. Then press the *MODE* button (14) again.  
⇒ *Automatic* mode is selected.

### Continuous operation

The device dehumidifies the air constantly and regardless of the relative room humidity.

The relative room humidity and the fan speed cannot be set in this operating mode.

1. Press the *MODE* button (14).  
⇒ The indication of the currently selected operating mode flashes.
2. Press the arrow buttons (18, 19) until the LED for *continuous operation* (13) starts flashing.
3. Then press the *MODE* button (14) again.  
⇒ *Continuous operation* is selected.

## Laundry drying function

The device may be used to dry clothes in a more timely manner. When positioning the device or a clothes horse, please observe the minimum distances specified in the technical data.

The device dehumidifies the air constantly and regardless of the relative room humidity. The fan runs at the highest speed.

The relative room humidity and the fan speed cannot be set in this operating mode.

1. Press the *MODE* button (14).
  - ⇒ The indication of the currently selected operating mode flashes.
2. Press the arrow buttons (18, 19) until the LED for the *laundry drying function* (13) starts flashing.
3. Then press the *MODE* button (14) again.
  - ⇒ The *laundry drying function* is selected.

## Ventilation

In *ventilation* mode you can choose between low and high fan speed.

1. Press the *MODE* button (14).
  - ⇒ The indication of the currently selected operating mode flashes.
2. Press the arrow buttons (18, 19) until the LED for *ventilation* mode (13) starts flashing.
3. Then press the *MODE* button (14) again.
  - ⇒ *Ventilation* mode is selected.
4. Press the *FAN* button (17) to select either low or high fan speed.
  - ⇒ The selected fan speed is indicated on the *fan speed* indication (21).

## Colour LED for current room humidity

Regardless of the operating mode, the colour LED indicates the current relative room humidity by means of 3 different colours.

LED colour	Meaning
Blue	Relative room humidity below 55 %
Green	Optimal relative room humidity between 55 and 70 %
Red	Illuminated: relative room humidity above 70 % Flashes: water tank full or not inserted correctly (accompanied by an acoustic signal)

## Setting the timer

Using the timer function, the device can be switched off automatically after a preset number of hours.

The number of hours can range from 1 to 24 and can be adjusted in increments of 1 h.

### Note

Do not leave the operating device unattended in a freely accessible room with an activated timer.

- ✓ The device is switched on.

1. Press the *TIMER* button (16).
  - ⇒ The number of hours flashes in the segment display (12).
2. Press the arrow buttons (18, 19) to set the desired number of hours.
3. Wait for approx. 5 seconds in order to save the setting.
  - ⇒ The *Timer* indication (11) is illuminated.
  - ⇒ The relative room humidity is indicated in the segment display (12) again.
  - ⇒ The device switches off after the set period of time.

## Memory function

The device memorizes the last selected operating mode, and in *dehumidification* mode (13) also the set room humidity, provided the device is switched off manually by pressing the On/Off button (15) and remains connected to the mains.

During short power failures, the device does **not** memorize the settings. The device starts in *automatic* mode (13) in this case.

## Child lock

1. Press the arrow buttons (18, 19) simultaneously for approx. 3 seconds to enable the child lock.
  - ⇒ An acoustic signal is emitted.
  - ⇒ The *child lock* indication (20) is illuminated.
2. Press the arrow buttons (18, 19) simultaneously for approx. 3 seconds to disable the child lock.
  - ⇒ An acoustic signal is emitted.
  - ⇒ The *child lock* indication (20) disappears.

## Auto stop function

If the water tank is full, not inserted correctly or the relative room humidity has been reached, the device will stop automatically.

**Operation with hose attached to the condensation connection**

For continuous operation or unattended dehumidification, please connect the supplied condensation drain hose to the device.

- ✓ A suitable hose (diameter: 17 mm) is ready for use.
- ✓ The device is switched off.

1. Remove the sealing cap from the hose connection.

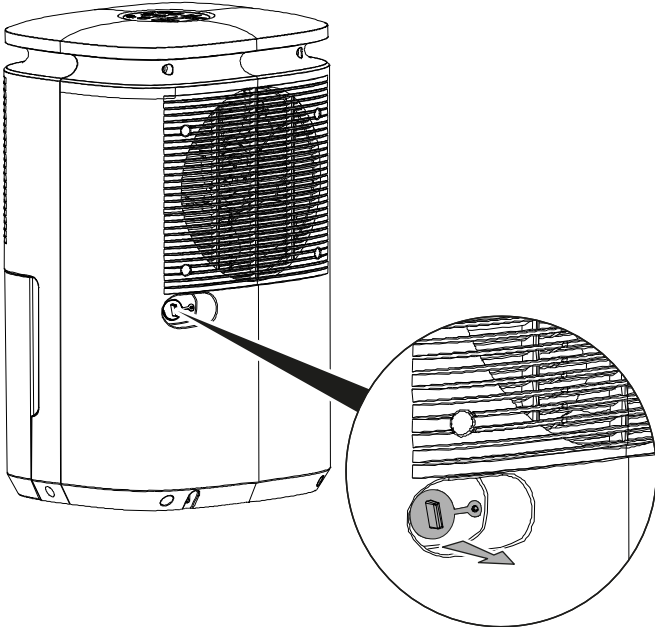

2. Push one end of the hose onto the hose connection.

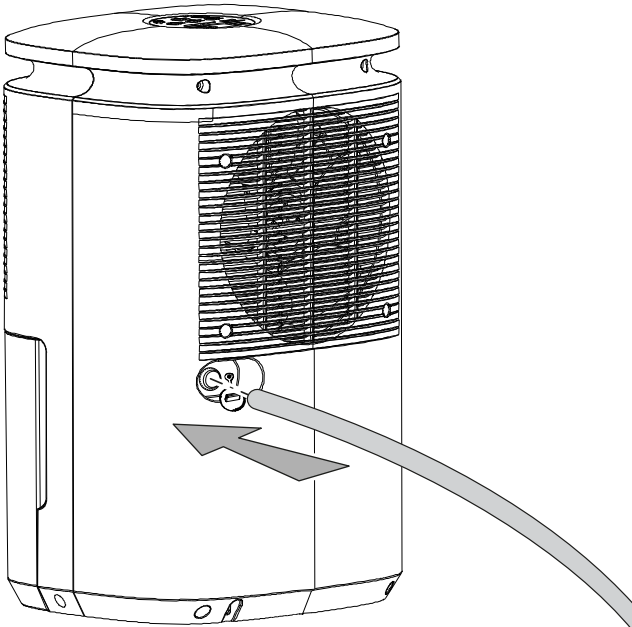

3. Guide the other hose end to a suitable drain or sufficiently dimensioned collection container. Please observe that the hose must not be kinked.

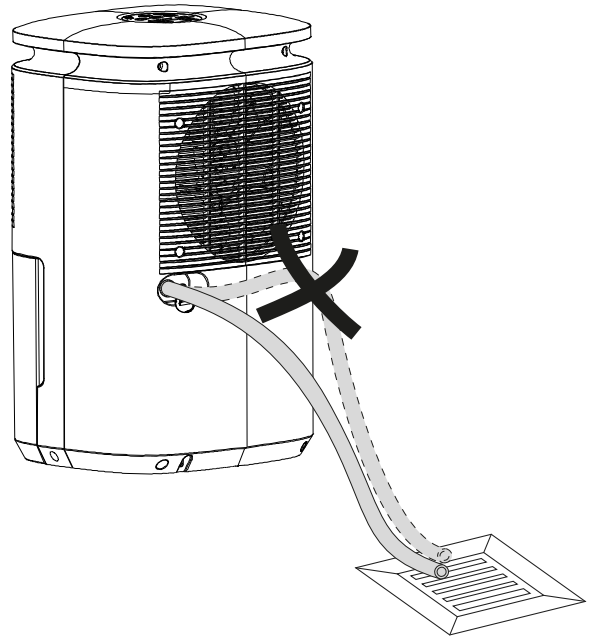

Remove the hose if you want to collect the condensate in the condensation tank again. Allow the hose to dry prior to storage. The hose can be connected in any operating mode for continuous operation.

**Automatic defrost**

At low ambient temperatures, ice may form at the evaporator during dehumidification. The device will then carry out an automatic defrost. Dehumidification is briefly interrupted during defrosting.

The duration of the defrost process can vary. Do **not** switch off the device during automatic defrost. Do **not** remove the mains plug from the mains socket.

The *Defrost* indication (22) is illuminated during automatic defrosting.

**Drying laundry**

In addition, the device may also be used as a kind of clothes dryer to dry wet laundry.

For drying laundry the following values should be selected:

- cupboard dry = 46 % relative humidity
- iron dry = 58 % relative humidity
- slightly dried = 65 % relative humidity

If necessary, use a measuring device to determine the humidity level.

## Shutdown



### Warning of electrical voltage

Do not touch the mains plug with wet or damp hands.

- Switch off the device.
- Hold onto the mains plug while pulling the power cable out of the mains socket.
- If necessary, remove the condensation drain hose and any residual fluid from it.
- Empty the condensation tank, if need be.
- Clean the device according to the Maintenance chapter.
- Store the device according to the Storage chapter.

## Errors and faults

The device has been checked for proper functioning several times during production. If malfunctions occur nonetheless, check the device according to the following list.

### The device does not start:

- Check the power connection.
- Check the power cable and mains plug for damages.
- Check the on-site fusing.
- Check the filling level of the condensation tank and empty it if necessary. The *Tank Full* indication (23) must not light up.
- Check the condensation tank for correct seating.
- Wait for 10 minutes before restarting the device. If the device is not starting, have the electricians checked by a specialist company or by Trotec.

### The device is running, but no condensate forms:

- Check the float in the condensation tank for dirt. If necessary, clean the condensation tank. The float must be able to move freely.
- Check the room temperature. Observe the device's permissible operating range according to the technical data.
- Ensure that the relative room humidity complies with the technical data.
- Check the preselected desired room humidity level. The relative humidity in the room must be above the selected range. If necessary, reduce the preselected desired room humidity.
- Check whether the device is running in automatic mode. In this case, the compressor switches off automatically once the relative room humidity is below 55 %.

- Check the air filter for dirt. If necessary, clean or replace the air filter.
- From the outside, check the condenser for dirt (see chapter Maintenance). If the condenser is dirty, have it cleaned by a specialist company or by Trotec.
- The device might carry out an automatic defrost. During automatic defrost, the device does not dehumidify.

### The device is loud or vibrates:

- Check whether the device is set up in a stable and upright position.

### Condensate is leaking:

- Check the device for leaks.

### The compressor does not start:

- Check the room temperature. Observe the device's permissible operating range according to the technical data.
- Ensure that the relative room humidity complies with the technical data.
- Check the preselected desired room humidity level. The relative humidity in the room must be above the selected range. If necessary, reduce the preselected desired room humidity.
- Check whether the device is running in automatic mode. In this case, the compressor switches off automatically once the relative room humidity is below 55 %.
- Check whether the overheating protection of the compressor has tripped. Disconnect the device from the mains and let it cool down for approx. 10 minutes before reconnecting it.
- The device might carry out an automatic defrost. During automatic defrost, the device does not dehumidify.

### The device gets very warm, is loud or loses power:

- Check the air inlets and air filter for dirt. Remove external dirt.
- From the outside, check the device for dirt (see chapter Maintenance). If the inside of the device is dirty, have it cleaned by a specialist company for cooling and air-conditioning or by Trotec.

### Note

Wait for at least 3 minutes after maintenance and repair work. Only then switch the device back on.

### Your device still does not operate correctly after these checks?

Please contact the customer service. If necessary, bring the device to a specialist company for cooling and air-conditioning or to Trotec for repair.

## Maintenance

## Maintenance intervals

Maintenance and care interval	before every start-up	as needed	at least every 2 weeks	at least every 4 weeks	at least every 6 months	at least annually
Empty condensation tank and drain hose		X				
Check the air inlets and outlets for dirt and foreign objects and clean if necessary	X			X		
Clean the exterior		X				X
Visually check the inside of the device for dirt		X				X
Check the air filter for dirt and foreign objects and clean or replace if necessary	X		X			
Replace air filter					X	
Check for damage	X					
Check the attachment screws		X				X
Test run						X

## Maintenance and care log

Device type: .....

Device number: .....

Maintenance and care interval	1	2	3	4	5	6	7	8	9	10	11	12	13	14	15	16
Empty condensation tank and drain hose																
Check the air inlets and outlets for dirt and foreign objects and clean if necessary																
Clean the exterior																
Visually check the inside of the device for dirt																
Check the air filter for dirt and foreign objects and clean or replace if necessary																
Replace air filter																
Check for damage																
Check the attachment screws																
Test run																
Remarks:																

1. Date: ..... Signature: .....	2. Date: ..... Signature: .....	3. Date: ..... Signature: .....	4. Date: ..... Signature: .....
5. Date: ..... Signature: .....	6. Date: ..... Signature: .....	7. Date: ..... Signature: .....	8. Date: ..... Signature: .....
9. Date: ..... Signature: .....	10. Date: ..... Signature: .....	11. Date: ..... Signature: .....	12. Date: ..... Signature: .....
13. Date: ..... Signature: .....	14. Date: ..... Signature: .....	15. Date: ..... Signature: .....	16. Date: ..... Signature: .....

## Activities required before starting maintenance



### Warning of electrical voltage

Do not touch the mains plug with wet or damp hands.

- Switch off the device.
- Hold onto the mains plug while pulling the power cable out of the mains socket.



### Warning of electrical voltage

**Maintenance tasks which require the housing to be opened must only be carried out by authorised specialist companies or by Trotec.**

## Cleaning the housing

Clean the device with a soft, damp and lint-free cloth. Ensure that no moisture enters the housing. Protect electrical components from moisture. Do not use any aggressive cleaning agents such as cleaning sprays, solvents, alcohol-based or abrasive cleaners to dampen the cloth.

## Visual inspection of the inside of the device for dirt

1. Remove the air filter.
2. Use a torch to illuminate the openings of the device.
3. Check the inside of the device for dirt.
4. If you see a thick layer of dust, have the inside of the device cleaned by a specialist company for cooling and air-conditioning or by Trotec.
5. Put the air filter back in.

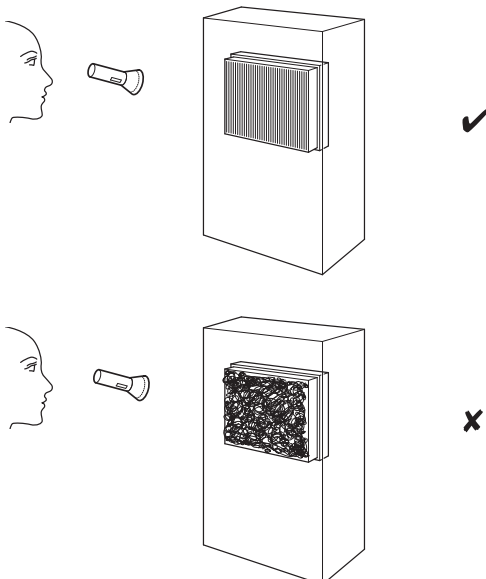

## Cleaning the air filter

### Note

Ensure that the air filter is not worn or damaged. The corners and edges of the air filter must not be deformed or rounded. Before reinserting the air filter, make sure that it is undamaged and dry!

The air filter has to be cleaned as soon as it is dirty. This is brought to light e.g. by a reduced capacity (see chapter Errors and faults).

1. Remove the air filter from the device.

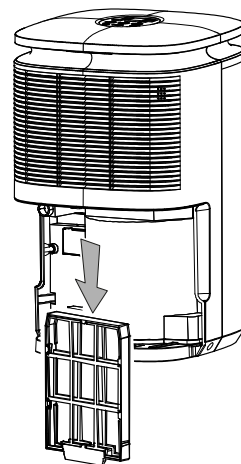
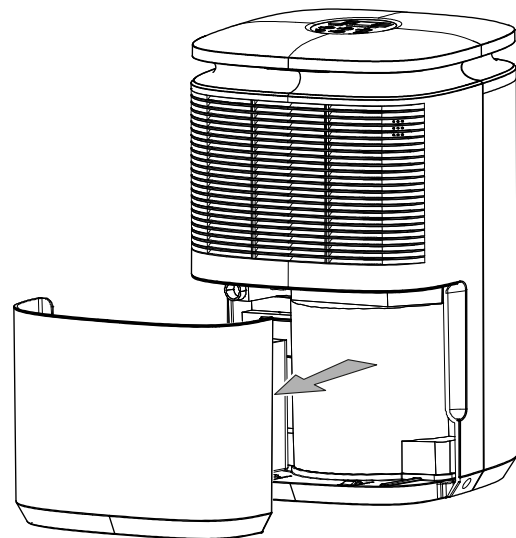

## Refrigerant circuit

- The entire refrigerant circuit is a maintenance-free, hermetically sealed system and may only be maintained or repaired by specialist companies for cooling and air-conditioning or by Trotec.

2. Clean the filter using a slightly damp, soft, lint-free cloth. If the filter is heavily contaminated, clean it with warm water mixed with a neutral cleaning agent.

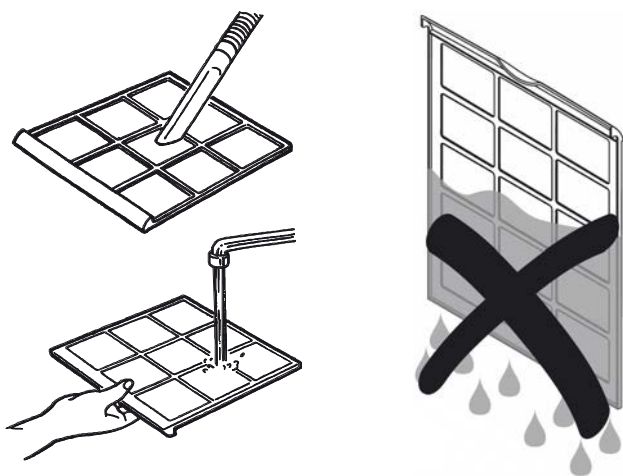

3. Allow the filter to dry completely. Do NOT insert a wet filter into the device!
4. Reinsert the air filter into the device.

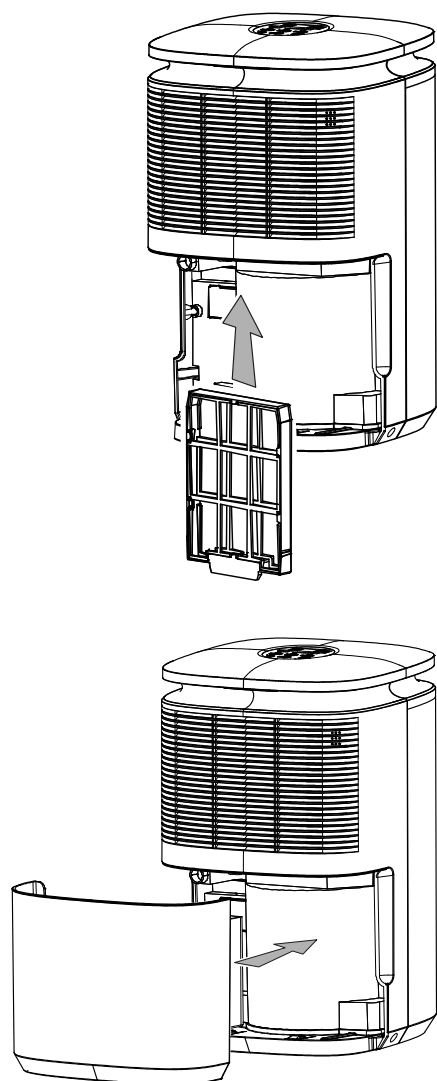

### Emptying the condensation tank

If the condensation tank is full or not inserted correctly, an acoustic signal will be emitted. Furthermore, the colour LED for the current room humidity (10) flashes red and the *Tank Full* indication (23) is illuminated. The compressor and fan will switch off.

1. Take the condensation tank out of the device.

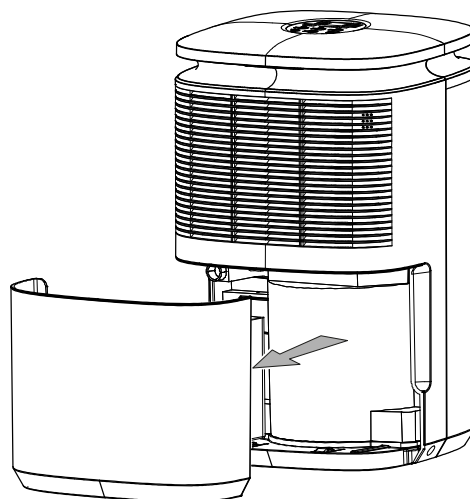

2. Empty the condensation tank over a drain or sink.
3. Rinse the tank with clear water. Clean the tank regularly using a mild cleaning agent (no detergent!).
4. Refit the condensation tank into the device. Make sure not to damage the float when inserting or removing the condensation tank. In doing so, make sure that the float is positioned correctly. In doing so, make sure that the condensation tank is inserted correctly, for otherwise the device cannot be switched back on.

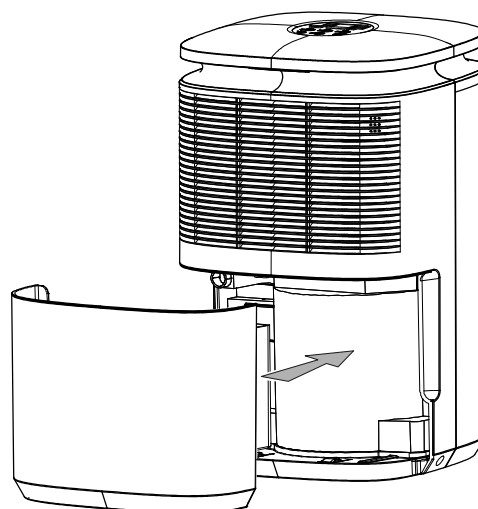

## Activities required after maintenance

If you want to continue using the device:

- Leave the device to rest for 12 - 24 hours, so the refrigerant can accumulate within the compressor. Wait 12 - 24 hours before switching the device back on! Acting contrary might lead to compressor damage and a malfunctioning device. If so, any warranty claims will be voided.
- Reconnect the device to the mains.

If you do not intend to use the device for a considerable time:

- Store the device according to the Storage chapter.

## Technical annex

### Technical data

Parameter	Value
<b>Model</b>	<b>TTK 30 E</b>
Max. dehumidification performance	12 l / 24 h
Dehumidification performance @ 30 °C and 80 % RH	10 l / 24 h
Air volume flow	120 m <sup>3</sup> /h
Ambient temperature	5 °C to 32 °C
Operating range relative humidity	30 % to 80 % RH
Mains connection	1/N/PE ~ 230 V/ 50 Hz
Power input	0.27 kW
Nominal current	1.35 A
Refrigerant	R134a
Amount of refrigerant	50 g
Condensation tank capacity	2.2 l
Sound pressure level (1 m distance)	45 dB(A)
Dimensions (length x width x height)	220 x 280 x 415 (mm)
Minimum distance to walls and other objects	A: top: 30 cm B: rear: 30 cm C: side: 20 cm D: front: 20 cm
Weight	9 kg

### Wiring diagram

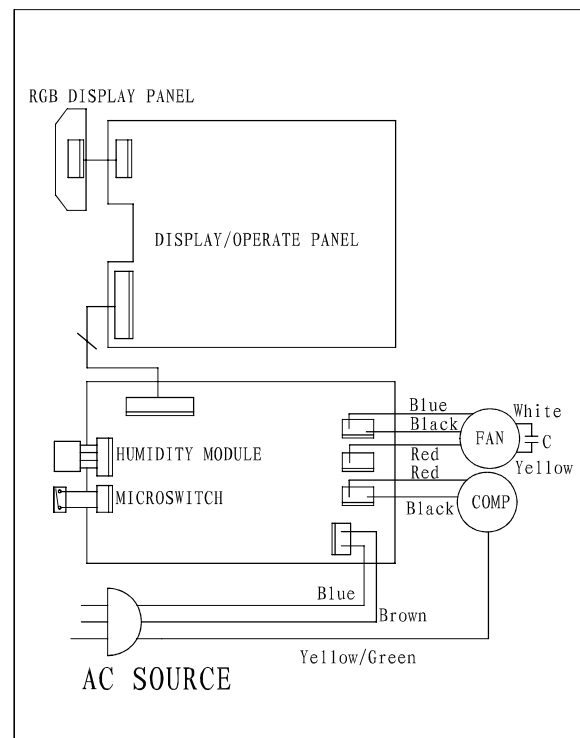

**Spare parts drawing and list**



**Info**

The position numbers of the spare parts differ from those describing the positions of other parts mentioned in this operating manual.

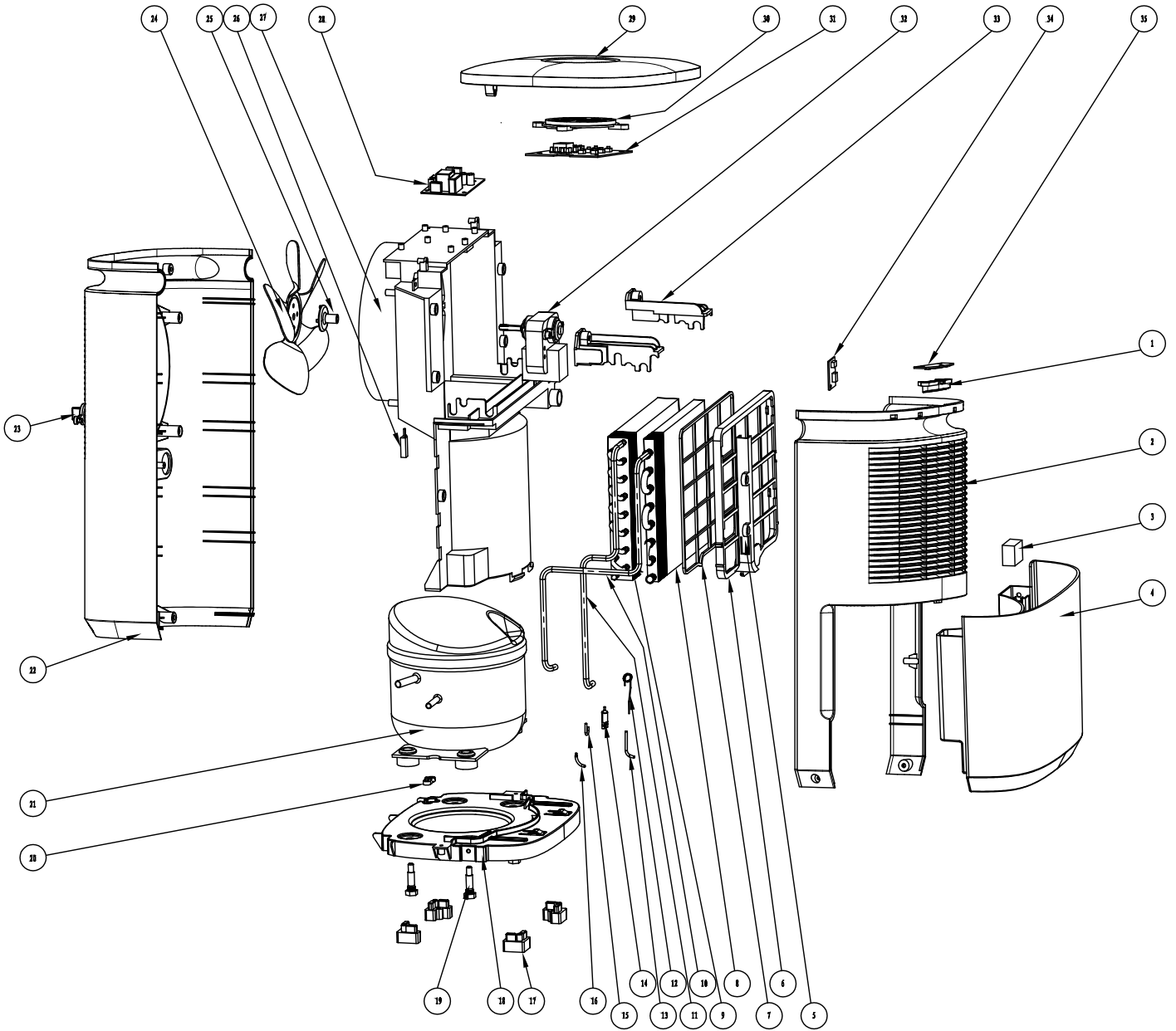

No.	Spare part	No.	Spare part	No.	Spare part
1	Decorative lights	13	Chill-out pipe	25	Fan?buckle
2	The front cover	14	Two-pass filter	26	Dry reed pipe
3	Float	15	Process pipe	27	Subject
4	Water tank	16	Capillary nozzle	28	Power board
5	Filter stent group	17	Ottomans	29	Cover
6	Filter box	18	Floor	30	Electronic Keypad
7	Filter plate	19	Pump foot bolt	31	Operation board
8	Evaporator	20	Pressing line plate	32	Motor
9	Condenser	21	Compressor	33	Two filter plate group
10	Return pipe	22	Back cover	34	Humidity Sensor
11	Exhaust pipe	23	Water plug	35	Light board
12	Capillary soft state	24	The wind wheel		

## Disposal



■ In the European Union, electronic equipment must not be treated as domestic waste, but must be disposed of professionally in accordance with Directive 2002/96/EC of the European Parliament and of the Council of 27 January 2003 on waste electrical and electronic equipment (WEEE). At the end of its life, please dispose of this device according to the valid legal requirements.

The device uses an environmentally and ozone-neutral cooling agent (see Technical Data).

Dispose of the refrigerant appropriately and according to the national regulations.





Trotec GmbH & Co. KG

Grebener Str. 7  
D-52525 Heinsberg

☎ +49 2452 962-400

☎ +49 2452 962-200

✉ [info@trotec.com](mailto:info@trotec.com)

[www.trotec.com](http://www.trotec.com)